

# CAMLOCK QUICK COUPLING

■ Stainless Steel ■ Aluminium Alloy ■ Polypropylene

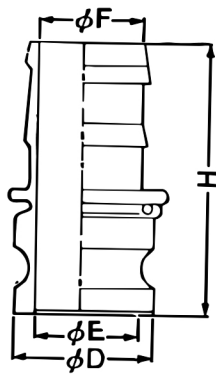

## TYPE E Hose Shank Adapter

TYPE NO	E050	E075	E100	E125	E150	E200	E250	E300	E400	E500	E600
Sizes	1/2	3/4	1	1-1/4	1-1/2	2	2-1/2	3	4	5	6
D	-	32	37	45	53	63	76	92	120	146	176
E	-	19	24	30	39	46	60	73	102	122	148
F	-	15	20	27	33	45	56	68	93	117	142
H	-	89	106	110	113	130	142	158	178	200	220

- This is designed with shank ends which can be attached directly to uncoupled rubber hose or vinyl chloride hose with any type clamps or bands.
- Please use dust cap in order to prevent abrasion and provide all inside surface with complete protection from dust, dirt or other foreign matter.

\*\*\*Product's specification may subject to change without further notice.  
\*\*\*Actual product may slightly differ from pictures shown.

**ESM038-E**  
**(31/12/09)**